



Station Recovery Log

Station #: 12 A
 Project Name: CLINTON CO
 Job Number: 57526
 Local Date: 11.23.99
 Name: JCB

TO-REACH DIRECTIONS

FROM 28/123 IN BLANCHESTER
 GO SOUTH ON RT. 123 FOR
 1.1 MILES TO SPA, ON LEFT

7,69,68 photo

STATION LOCATION

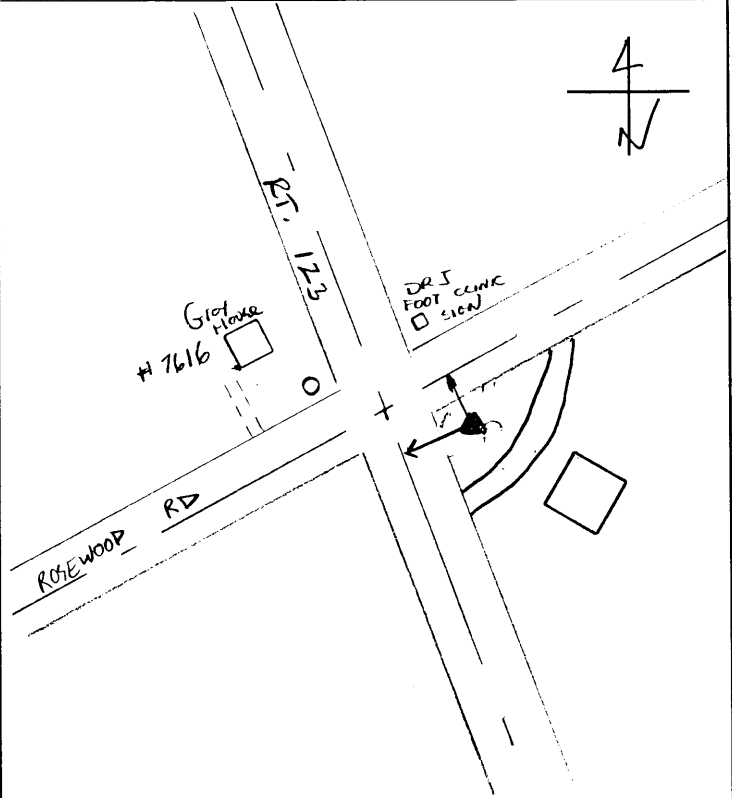

REFERENCES

Reference Object	Distance	Azimuth
☒ Rosewood Dr	17'	
☒ Rt 123	20'	

VISIBILITY DIAGRAM

No Obstructions

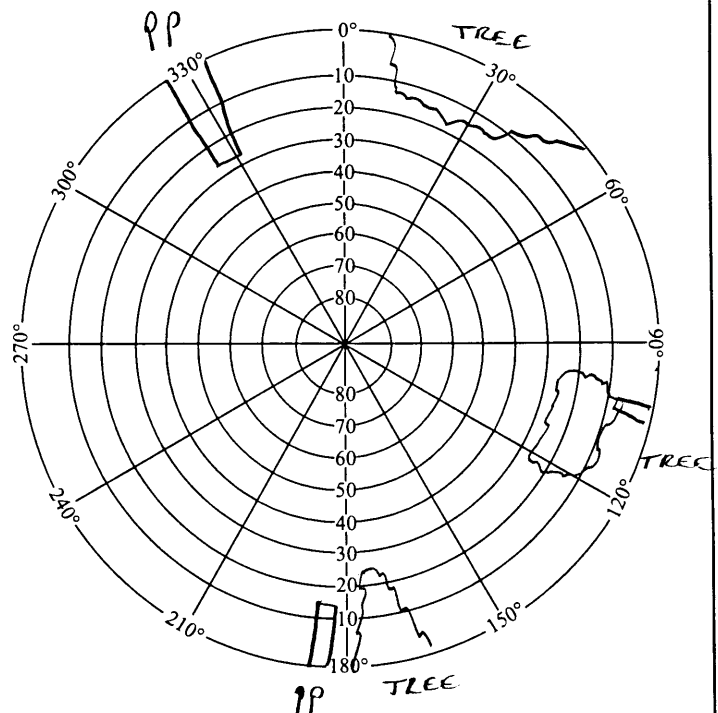

DISC DETAIL

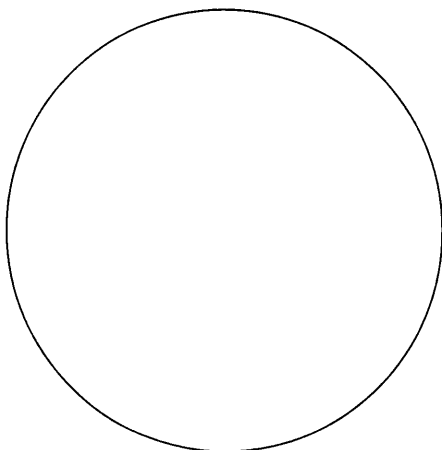



GPS STATION LOG

Station Name: 2012 Project Name: CLINTON CO.
 Receiver No.: 1A Job Number: 57526
 Day of Year: 129 Local Date: 4-3-00
 Session No.: C Operator: T. R. ...

C/A CODE POSITION

Lat: 39° 16' 46" N
 Long: 83° 58' 36" W
 Ellip. Height: 290.2 M

Trimble: 4000 SSE, 4000 SSL, Other _____
 Antenna: Kinematic, Compact, Groundplane, Dome
 Battery No.: _____
 Tribrach No.: _____
 File Name: 0014-129-C

Antenna H.I. => Before: 2.063 M _____ Ft Actual => Start 18:07 Stop 22:04 UTC
 After: 2.063 M _____ Ft Start 2:07P Stop 3:04P Local
 Rapid Static, Static, Kinematic Survey Local-UTC Time Offset: 4

SV's Used: 02, 04, 05, 07, 09, 16, 24 Weather: 55° CLOUDY (0111)

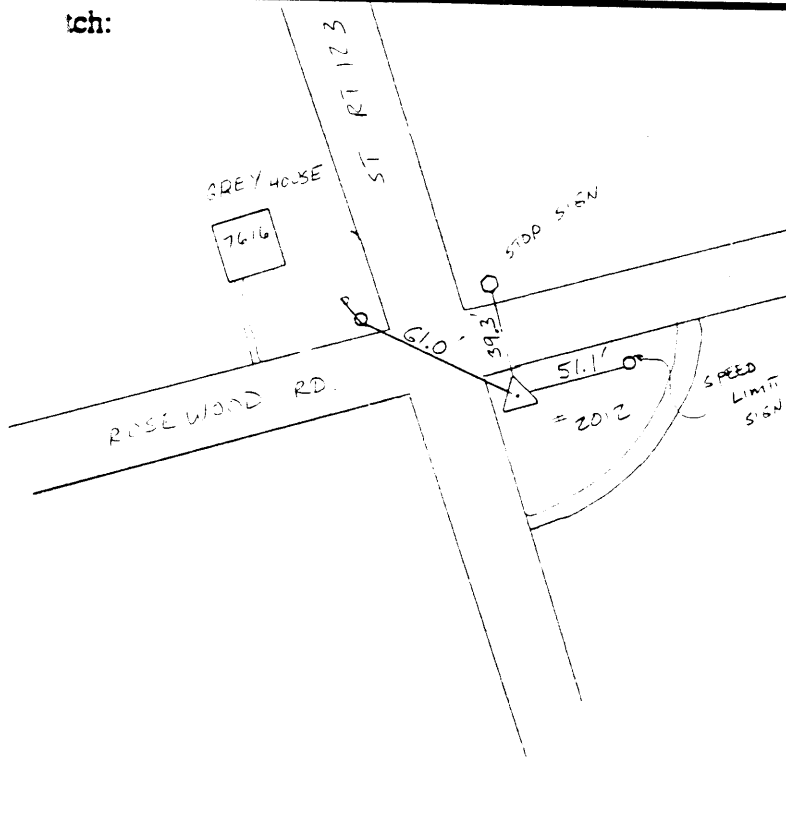

Description:

of Mark: CONC. MON. w/ BRASS
 Stamping: 12A
 Agency: CLINTON Co. Auditor & ENGINEER

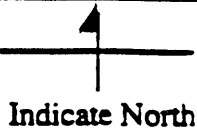

Remarks: DRY 56.3
 WET 48.6
 R. Hum 57%
 BAR 29.01



GPS STATION LOG

Station Name: 2012
 Receiver No.: 1372
 Day of Year: 110
 Session No.: A

Project Name: CLINTON CO
 Job Number: 57526
 Local Date: 19-APR-08
 Operator: ETR

C/A CODE POSITION
 Lat: 39 ° 16 ' 46 " N
 Long: 083 ° 58 ' 36 " W
 Ellip. Height: _____ M

Trimble: 4000 SSE, 4000 SSL, Other _____
 Antenna: Kinematic, Compact, Groundplane, Dome
 Battery No.: #1372 / #057732
 Tribrach No.: FHT - 2.00m
 File Name: 1372-110-A

Antenna H.I. ⇒ Before: 2.063TV M _____ Ft
 #057732 After: 2.063TV M _____ Ft
Rapid Static, Static, Kinematic Survey

Actual ⇒ Start 12:13 Stop 13:02 UTC
 Start 8:13 Stop 9:02 Local
 Local-UTC Time Offset: -4HR

SV's Used: _____ Weather: _____

Sketch:

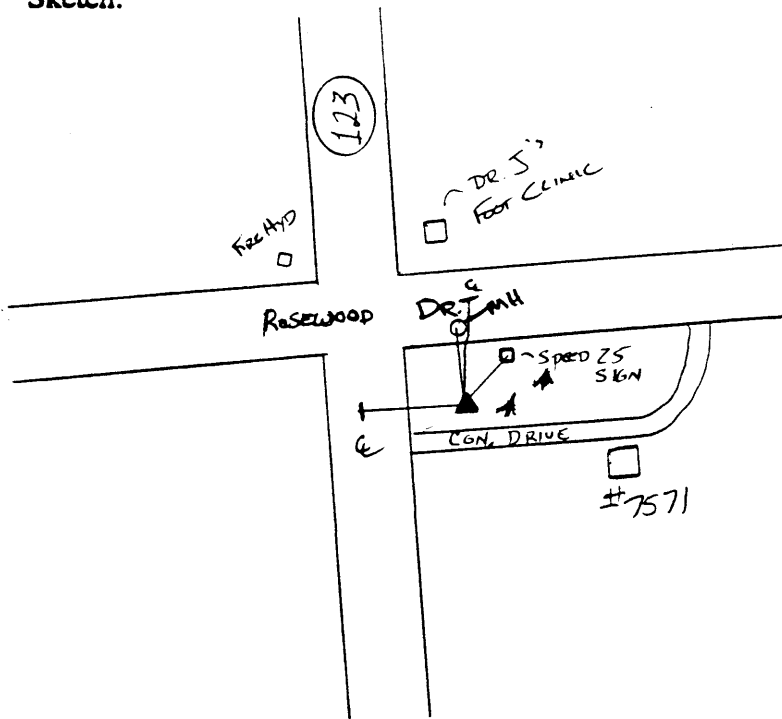

Description:

*SE QUADRANT OF INSECT. 123 w/ ROSEWOOD.

MH = 4.22m
 E Rosewood = 6.15m
 E 123 = 7.13m
 Speed 25 SIGN = 15.72m

MET DATA:

DRY (°F) 57.4
 WET (°F) 51.1
 R.H. 65%
 B.P. 29.08
 CODE: 01111

Type of Mark: Clinton Co Disk 2000
 mping: 12A
 ency: Eng. Auditor's



Remarks: