



WOOLPERT

Station Recovery Log

Station #: 10A
 Project Name: CLINTON CO.
 Job Number: 57526
 Local Date: 11.23.99
 Name: JCB

STATION LOCATION

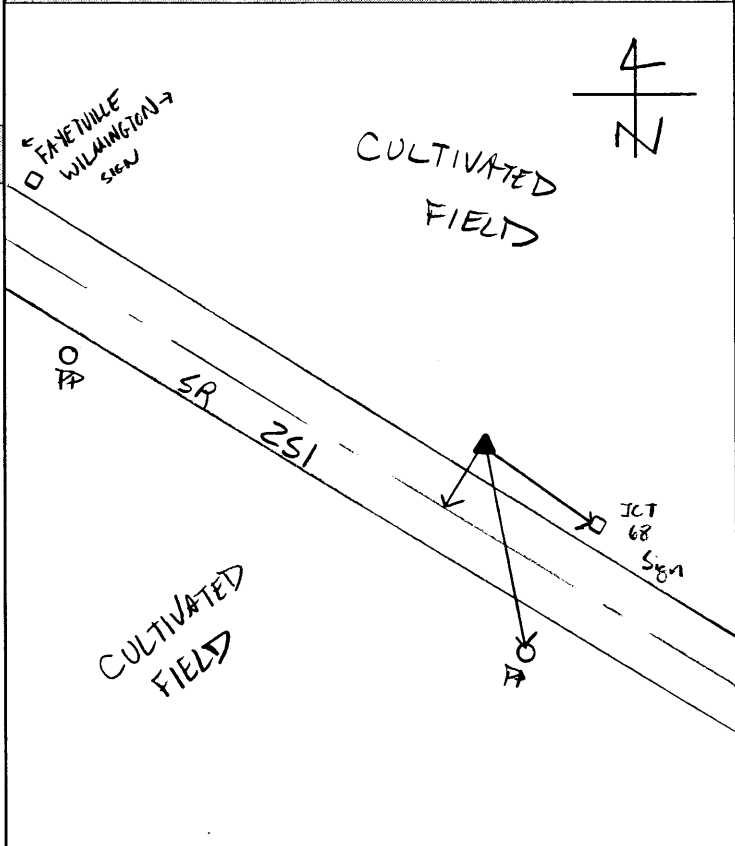

TO-REACH DIRECTIONS

From US 68 and SR 251
 take SR 251 south .15
 miles to station on left.

97+98

.15 to 68

REFERENCES

Reference Object	Distance	Azimuth
Jct 68 Sign	60'	
PP	75'	
E SR 251	23'	

VISIBILITY DIAGRAM

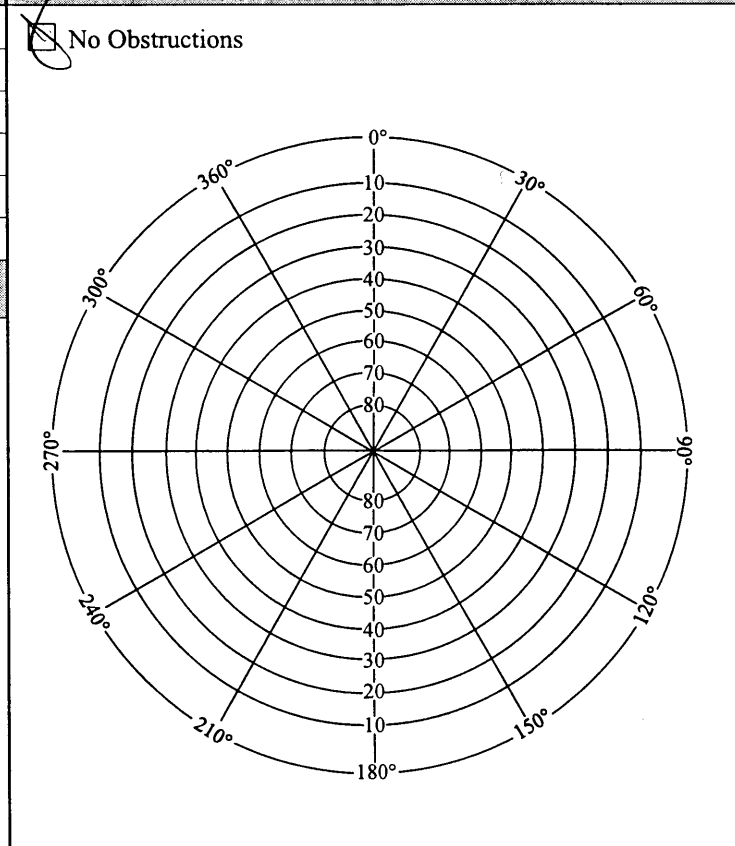

DISC DETAIL

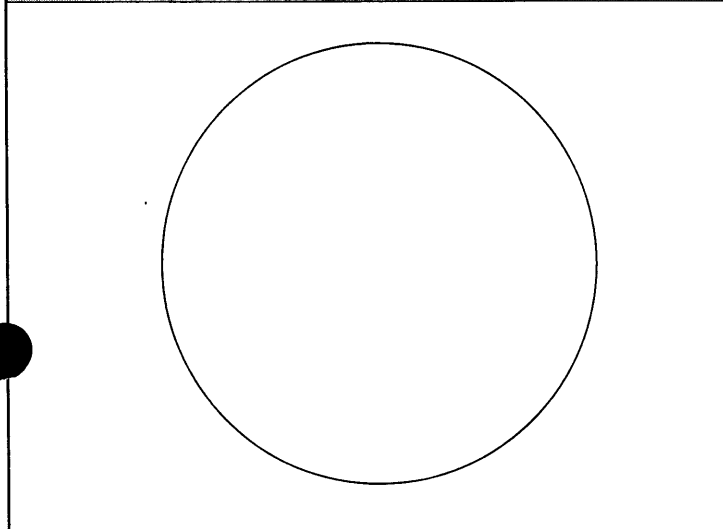

10A-1



GPS STATION LOG

Station Name: 2010 = 10A Project Name: CLINTON CO (BB)
 Receiver No.: 01 Job Number: 59526
 Day of Year: 110 Local Date: 19 APR 00
 Session No.: 7-A Operator: BJM

C/A CODE POSITION

Lat: 39° 15' 19.43" N Trimble: 4000 SSE, 4000 SSL, Other _____
 Long: 083° 54' 04.60" W Antenna: Kinematic, Compact, Groundplane, Dome
 Ellip. Height: 328.5 M Battery No.: ANT: 0220014069 REL: 3251A0222G
 Tribrach No.: FHT @ 3.00m
 File Name: 0001-110-A

Antenna H.I. => Before: 2.063 M 6.768 Ft Actual => Start 12:13 Stop 13:02 UTC
 After: 2.063 M 6.768 Ft Start 08:13 Stop 09:02 Local
Rapid Static, Static, Kinematic Survey TV Local-UTC Time Offset: 4 HR

SV's Used: 11, 27, 03, 08, 31, 13, 15, 18, 19 Weather: 01111

Sketch:

Description:

Type of Mark: BROWSE SURVEY DISK _____
 Mapping: 2000 10A _____
 Agency: CLINTON CO GIS AUDITOR/ENGINEER _____ Indicate North
 Remarks: DRY: 57.4°F REL: 65%
WET: 51.1°F PRES: 29.08" Hg



GPS STATION LOG

Station Name: 2010 Project Name: CLINTON CO
 Receiver No.: 01 Job Number: 57526
 Day of Year: 109 Local Date: 18 APR 00
 Session No.: A Operator: BJM

C/A CODE POSITION

Lat: 39° 15' 19.40" N
 Long: 083° 54' 05.75" W
 Ellip. Height: 242.9 M

Trimble: 4000 SSE, 4000 SSL, Other _____
 Antenna: Kinematic, Compact, Groundplane, Dome
 Battery No.: _____
 Tribrach No.: F+T @ 2.00m
 File Name: 0001-109-A

Antenna H.I. => Before: 2.063 M 6.768 Ft
 After: 2.063 M 6.768 Ft
Rapid Static, Static, Kinematic Survey TU

Actual => Start 15:40 Stop 16:38 UTC
 Start 11:40 Stop 12:38 Local
 Local-UTC Time Offset: 4HR

SV's Used: 02, 02, 27, 07, 08, 11 Weather: 01111

.tch:

Description:

Type of Mark: BRONZE SURVEY DISK
 Stamping: 10A
 Agency: CLINTON Co. AUDITOR & ENGINEER

Indicate North



Remarks:
DRY: 50.6°F Hum: 77%
WET 47.0°F PRES: 29.03 "Hg
01111



GPS STATION LOG

Station Name: 2010 Project Name: CLINTON CO
 Receiver No.: 1372 Job Number: 57526
 Day of Year: 110 Local Date: 19-APR-08
 Session No.: B Operator: ESR

C/A CODE POSITION
 Lat: 39 ° 15 ' 19 " N
 Long: 083 ° 54 ' 04 " W
 Ellip. Height: _____ M

Trimble: 4000 SSE, 4000 SSL, Other _____
 Antenna: Kinematic, Compact, Groundplane, Dome _____
 Battery No.: 1372 w/ 057732
 Tribrach No.: FRK-200m
 File Name: 1372-110-B

Antenna H.I. ⇒ Before: 2.063 TV M _____ Ft
 #057732 After: 2.063 TV M _____ Ft
 Actual ⇒ Start 13:15 Stop 14:07 UTC
 Start 9:15am Stop 10:07 Local
 Local-UTC Time Offset: -4 HR

Rapid Static, Static, Kinematic Survey

SV's Used: _____ Weather: _____

Sketch:

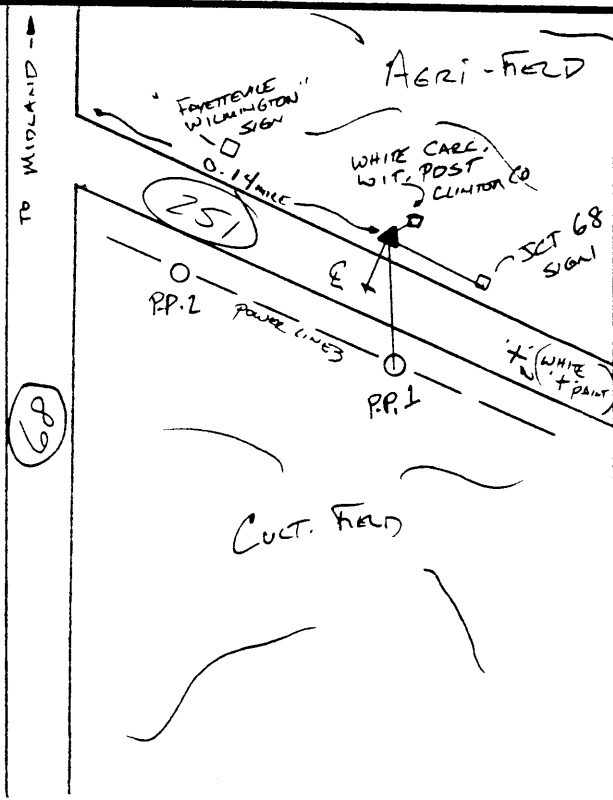

~~Description:~~ ACCESSORIES:
 E 251 - 7.70m @ NE
 JCT 68 SIGN - 21.05m @ NW
 PP.1 - 27.85m @ N
 CLINTON CO W/IT. POST - 0.19m @ NW

MET DATA:
 Dry (°F) = 55.9
 Wet (°F) = 49.3
 R.H. = 63%
 B.P. = 29.06
 CODE = 0111

Type of Mark: Dbk
 amping: 10A
 Agency: CLINTON CO ENGINEER Approved Notes

Indicate North

Remarks: