

- B-31, B.A. & CLARA H. TINCH
- C-31, W.C. MULLINS
- 1-12, L.G. & M.E. RAWSON
- 2-275, DONALD E. & JANICE BURTON
- 3-33, L.G. & M.E. RAWSON
- 4-21, NANCY MARCONETT
- 5-17, J.L. FISHER
- 6-16, E.B.C. HAYNE
- 7-26, CELIA E. PENNINGTON
- 8-246, " " "
- 9-15, WALTER C. MULLINS
- 10-24, CLEMENT HALL
- 11-41, ROBERT E. & BONNIE L. ZEIGLER
- 12-100, DONALD & JANICE BURTON
- 13-609, CLEM H. & GLADINE L. HALL

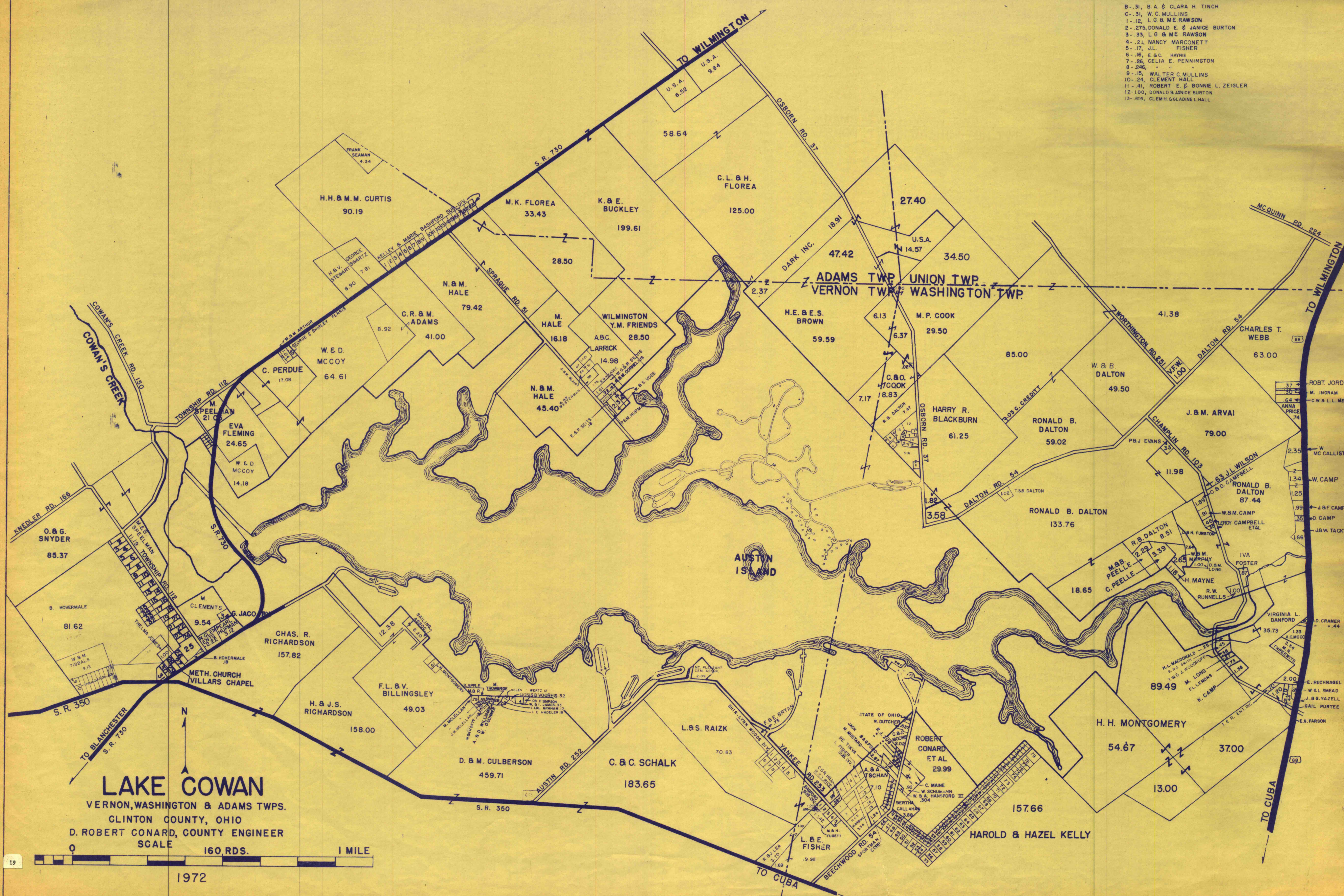

LAKE COWAN
 VERNON, WASHINGTON & ADAMS TWP.
 CLINTON COUNTY, OHIO
 D. ROBERT CONARD, COUNTY ENGINEER
 SCALE 160 RDS. 1 MILE