

**JOHN LYTLE CEMETERY**  
 CLINTON CO. CLARK TWP.  
 OFFICIAL PROJECT NO. 465-42-3-467 & 665-42-3-232

LEGEND	HISTORY
① REVOLUTION	SURVEY 2391 D. BRADFORD
⑩ WAR OF 1812	FIRST INTERMENT 1839 JOHN LYTLE
⑲ MEXICAN WAR	ORIGINAL OWNER GEN. WILLIAM LYTLE

SCALE 20' = 1" .01 ACRE

WAR	LOT	GRAVE
LYTLE, JOHN	⑩	1

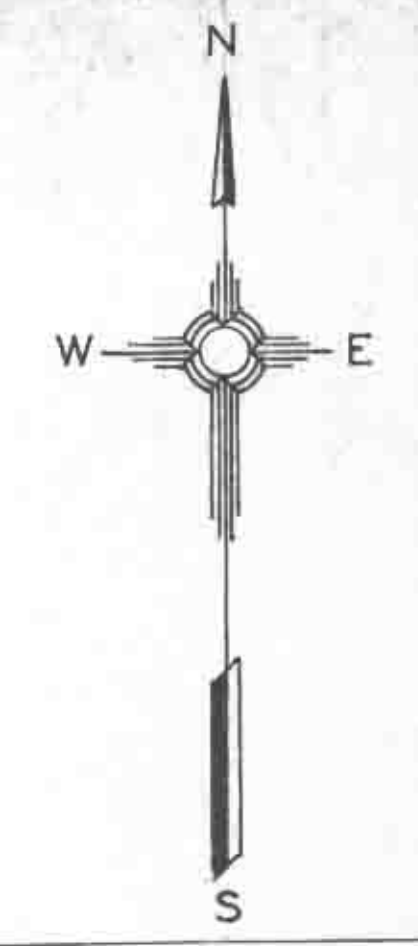
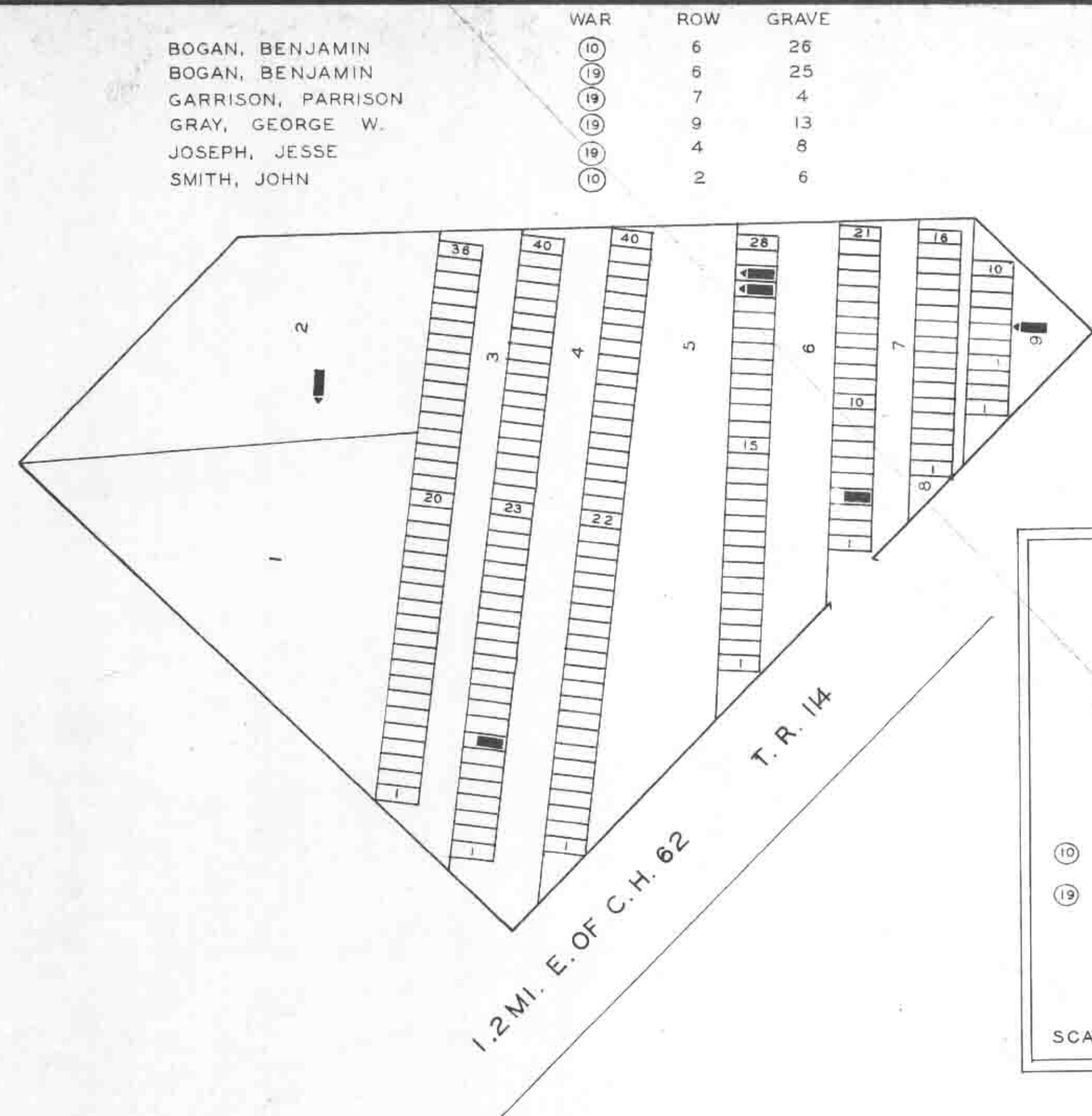

**REHOBATH CEMETERY**  
 CLINTON CO. VERNON TWP.  
 OFFICIAL PROJECT NO. 465-42-3-467 & 665-42-3-232

LEGEND	HISTORY
⑩ WAR OF 1812	EST. PRIOR TO 1840
⑲ CIVIL WAR	SURVEY 2706 A. JONES

SCALE 20' = 1" .50 ACRE

WAR	ROW	GRAVE
⑩	6	26
⑩	6	25
⑲	7	4
⑲	9	13
⑲	4	8
⑩	2	6

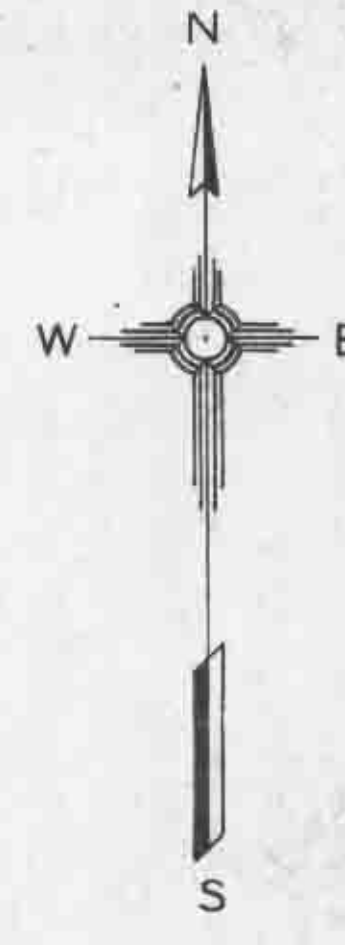
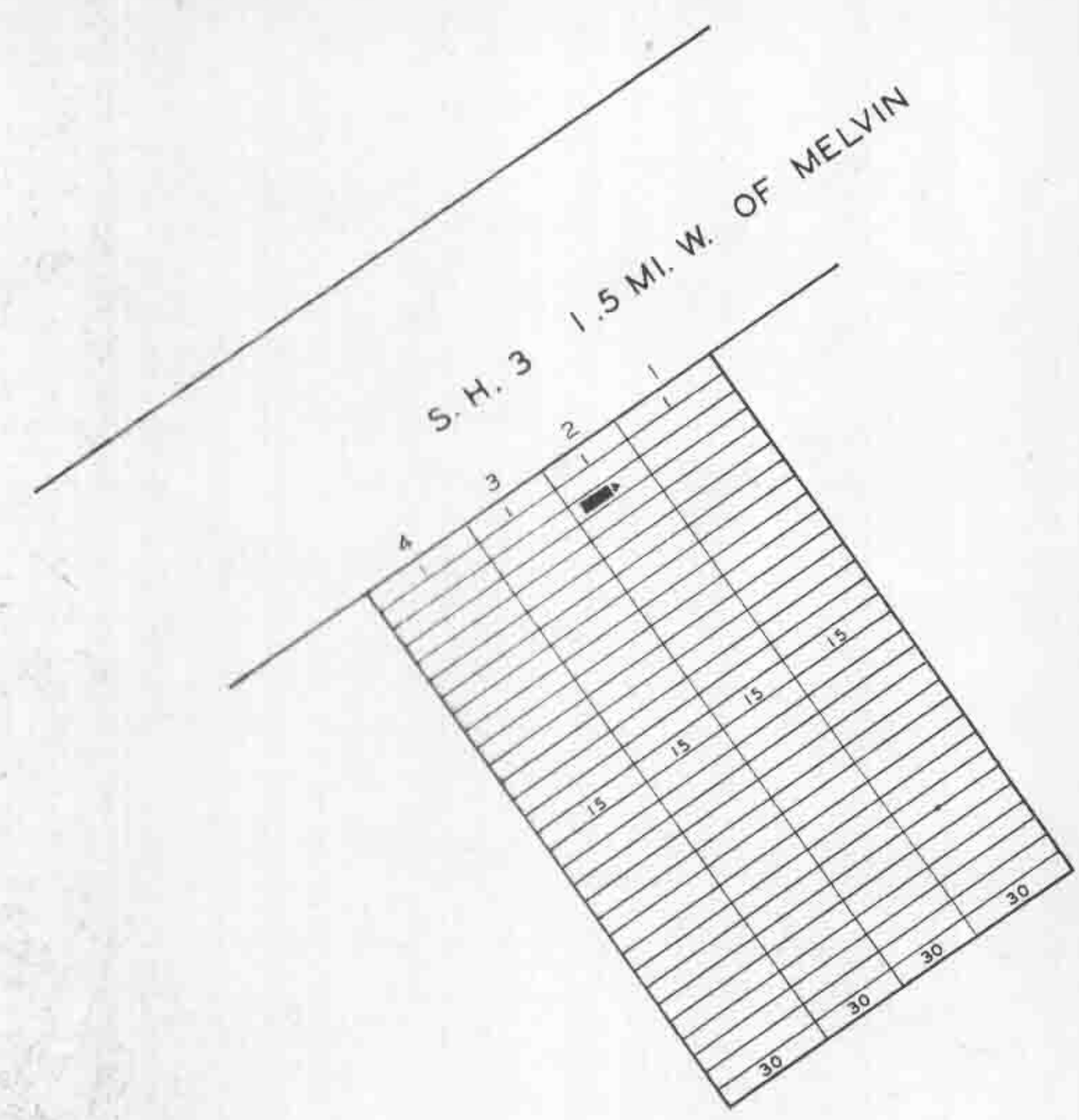

**WILSON CEMETERY**  
 CLINTON CO. UNION TWP.  
 OFFICIAL PROJECT NO. 465-42-3-467 & 665-42-3-232

LEGEND	HISTORY
① REVOLUTION	EST. ABOUT 1840 PREVIOUSLY CHRISTIAN CHURCH GROUNDS
⑩ WAR OF 1812	SURVEY 961 N. ANDERSON
⑲ CIVIL WAR	NOW ABANDONED

SCALE 20' = 1" .15 ACRE

WAR	ROW	GRAVE
WILSON, JAMES	⑩	2

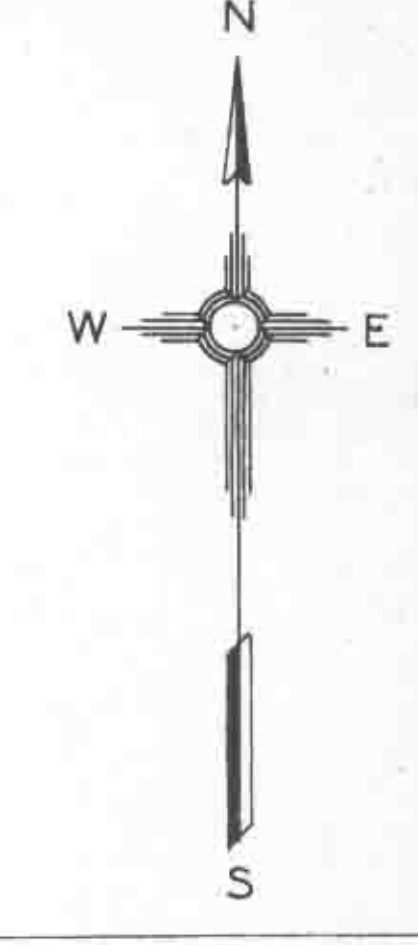
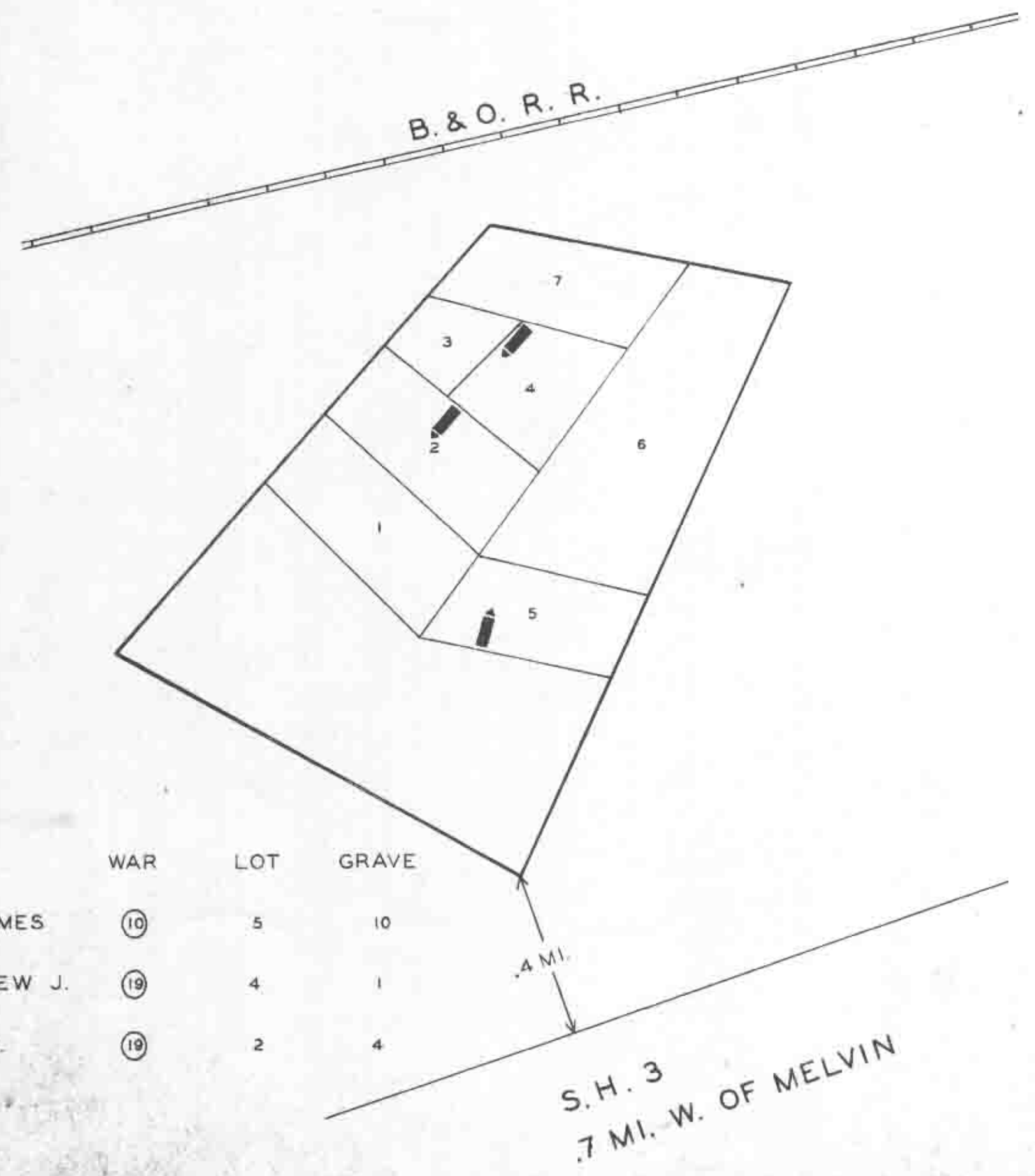

**WADE CEMETERY**  
 CLINTON CO. RICHLAND TWP.  
 OFFICIAL PROJECT NO. 465-42-3-467 & 665-42-3-232

LEGEND	HISTORY
① REVOLUTION	EST. ABOUT 1830 DONORS J. & G. WADE
⑩ WAR OF 1812	SURVEY 730 N. ANDERSON
⑲ CIVIL WAR	NOW ABANDONED

SCALE 20' = 1" .15 ACRE

WAR	LOT	GRAVE
TAYLOR, JAMES	⑩	5
WADE, ANDREW J.	⑲	4
WADE, H. E.	⑲	2