

**PETERSON**  
H. A. BEAM FARM  
**CEMETERY**  
CLINTON CO. CHESTER TWP.  
OFFICIAL PROJECT NO. 465-42-3-467 & 665-42-3-232  
**LEGEND HISTORY**  
EST. 1826  
ⓐ WAR OF 1812 SURVEY 2232 H. GATES  
SCALE 10' = 1" .15 ACRE

4.5 MI. TO NEW BURLINGTON C. H. 5

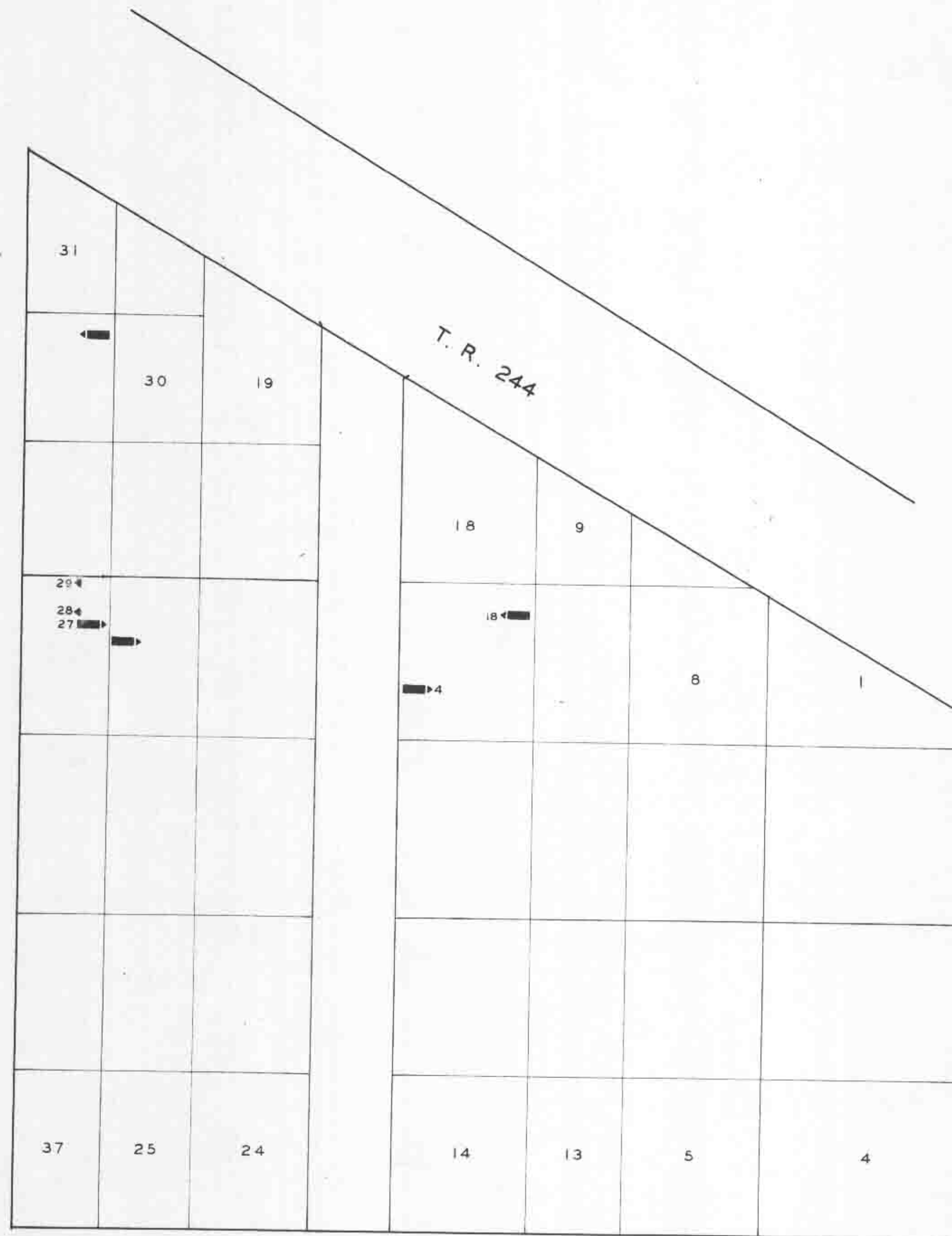

T. R. 244

NAME	WAR	LOT	GRAVE
JENKINS, EVAN	ⓐ	17	18
JOHNSON, JAMES	ⓑ	28	4
JOHNSON, JOHN H.	ⓐ	34	27
JOHNSON, GEORGE M.	ⓑ	34	29
JOHNSON, LEWIS	ⓑ	34	28
MC PHERSON, HENRY H.	ⓑ	17	4
WILSON, JOHN G.	ⓐ	32	19

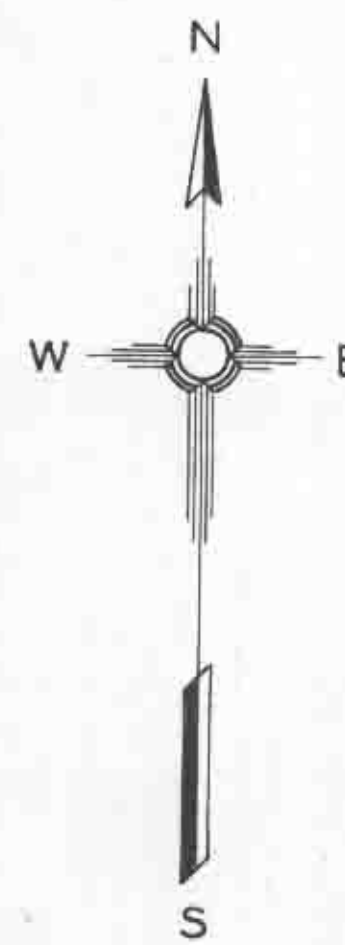

**HAWS CHAPEL**  
**CEMETERY**  
CLINTON CO. UNION TWP.  
OFFICIAL PROJECT NO. 465-42-3-467 & 665-42-3-232  
**LEGEND HISTORY**  
ⓐ WAR OF 1812 EST. 1882  
ⓑ MEXICAN WAR BY MRS. SARAH HAWS  
ⓑ CIVIL WAR  
ⓑ WAR WITH SPAIN SURVEY 2714 W. WHITE  
SCALE 20' = 1" .90 ACRE

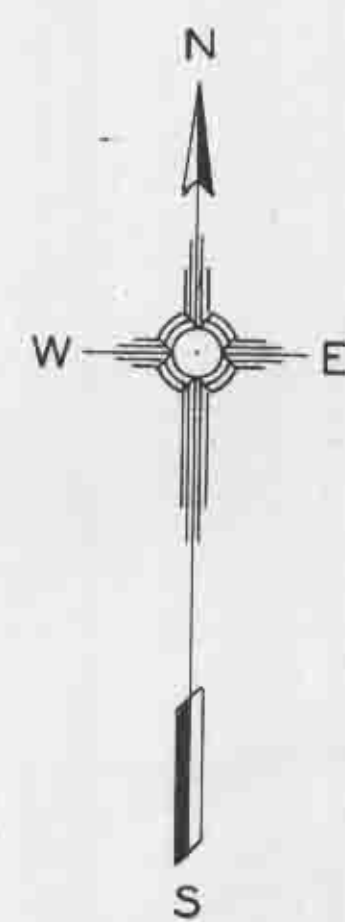
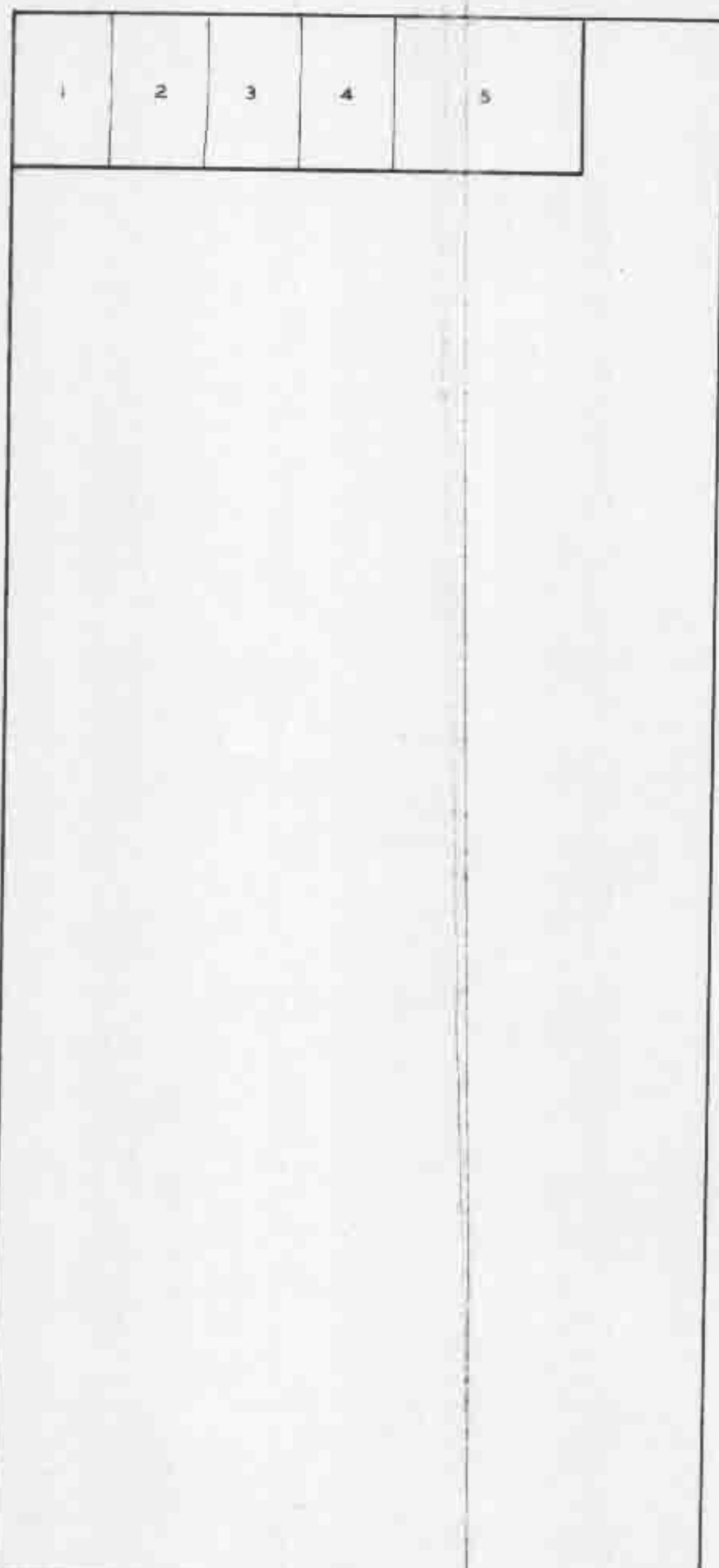

**MC KAY**  
**CEMETERY**  
CLINTON CO. LIBERTY TWP.  
OFFICIAL PROJECT NO. 465-42-3-467 & 665-42-3-232  
**LEGEND HISTORY**  
ⓑ CIVIL WAR EST. 1849  
ⓑ WAR WITH SPAIN SURVEY 3908  
ⓑ WORLD WAR R. POLLARD  
SCALE 20' = 1" .50 ACRE

C. H. 5 2 MI. TO LUMBERTON →